

AI Vandal Proof Bullet IP Camera

4K • AI • 120dB WDR • 0.012Lux Low-light • IP67 • IK10 • Smart IR II • 30m IR Distance • PoE



| MODEL | | TA-K88164-PD |
|--------|--------------------------|---|
| CAMERA | Image Sensor | 1/2.8" Progressive Scan CMOS Sensor |
| | Minimum Illumination | Colour: 0.012Lux @F1.6 B/W: 0Lux with IR on |
| | WDR | 120dB Super WDR |
| | Lens | 2.8mm/4mm/6mm@F1.6 |
| | Mount | M12 |
| | Field of View | H110°/D126°/V60°(2.8mm) H91°/D106°/V50°(4mm) H55°/D63°/V32°(6mm) |
| | Shutter Time | 1/100000s~1s |
| | IR Distance | Up to 30m |
| | Day/Night Mode | Day/Night/Auto/Customize/Schedule |
| | S/N Ratio | >55dB |
| VIDEO | Maximum Image Resolution | 3840x2160 |
| | Primary Stream | 60Hz/50Hz: 30fps@(3840x2160, 3072x2048, 2592x1944, 2592x1520, 2048x1536, 1920x1080, 1280x960, 1280x720, 704x576), 20fps@(3840x2160)(Optional for S Series) |
| | Secondary Stream | 60Hz: 30fps@(704x576, 640x480, 640x360, 352x288) 50Hz: 25fps@(704x576, 640x480, 640x360, 352x288) |
| | Tertiary Stream | 60Hz: 30fps@(1280x720, 704x576, 640x480, 640x360, 352x288) 50Hz: 25fps@(1280x720, 704x576, 640x480, 640x360, 352x288) |
| | Video Compression | H.265+/H.265(HEVC)/H.264+/H.264/MJPEG |
| | Video Bit Rate | 16Kbps~16Mbps(CBR/VBR Adjustable) |
| | Privacy Masking | Up to 4 areas |

| | | |
|-----------------------|----------------------|--|
| VIDEO | ROI | Up to 8 areas |
| | Image Setting | Brightness/Contrast/Saturation/Sharpness |
| INTERFACE | Ethernet | 1*RJ45 10M/100M Ethernet Port |
| NETWORK | Network Storage | NAS(Support NFS, SMB/CIFS), ANR |
| | Protocol | IPv4/IPv6, ARP, TCP, UDP, RTP, RTSP, HTTP, HTTPS, DNS, DDNS, DHCP, FTP, NTP, SMTP, SNMP, UPnP, Bonjour, SIP, PPPoE, VLAN, 802.1x, QoS, IGMP, ICMP, SSL |
| INTELLIGENT ANALYTICS | Video Analysis | Region Entrance, Region Exiting, Advanced Motion Detection, Tamper Detection, Line Crossing, Loitering, Object Left, Object Removed |
| SYSTEM | Storage | Support microSD/SDHC/SDXC Card Local Storage, up to 256G |
| | Advanced Function | BLC, HLC, 2D DNR, 3D DNR, Defog, AWB, IP Address Filtering, AGC, Anti-flicker, Corridor Mode, Deblur |
| | SIP/VoIP Support | Yes, Voice & Video-over-IP |
| | Event Trigger | Motion Detection, Network Disconnection, etc. |
| | Event Action | FTP Upload, SMTP Upload, SD Card Record, SIP Phone, HTTP Notification, etc. |
| | System Compatibility | ONVIF Profile G & Q & S & T, API |
| GENERAL | Working Temperature | -40°C~60°C |
| | Working Humidity | 0~90%(Non-condensing) |
| | Power Supply | PoE (802.3af) |
| | Power Consumption | 4.2W MAX / 5.8W MAX (With IR on) |
| | Weather Proof | Up to IP67-rated for Weather-resistant Performance |
| | Housing | Vandal-proof IK10-rated Metal Housing |
| | Weight | 610g (Junction Box Version) / 450g (Cable Out Version) |
| | Dimensions | 97mmX74mmX180mm (Junction Box Version) / 64mmX64mmX 160mm (Cable Out Version) |
| | Warranty | 3/5 Years |
| OPTIONS | TA-K88164-SPD | 4K AI Vandal Proof Bullet IP Camera Primary Stream – 20fps |

Structure Diagram:

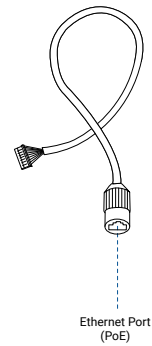
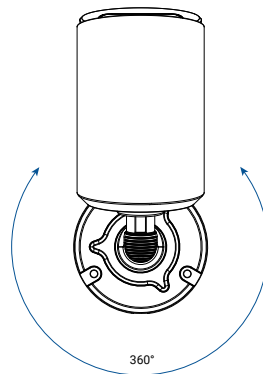
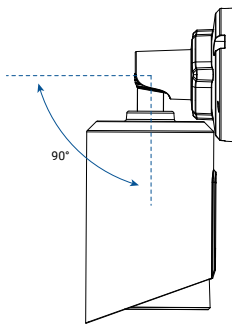
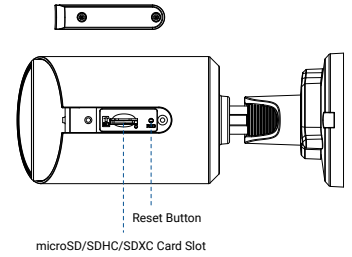
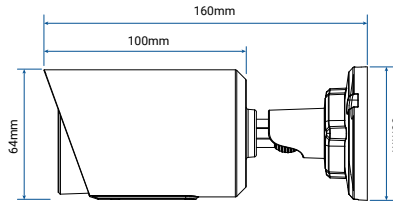
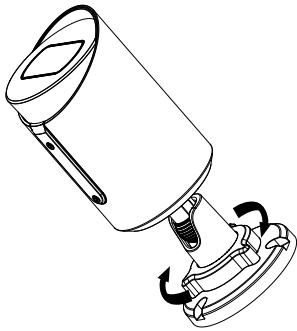
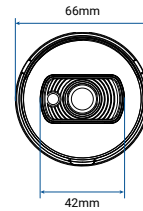
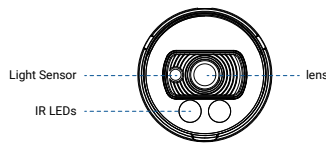
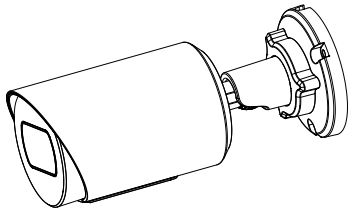

Accessories:

T01
POLE MOUNT

Weight: 720g
Dimensions:
170*51.5*152.6mm

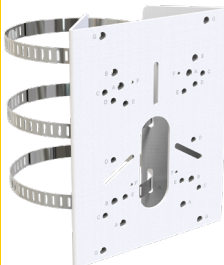

T03
EXTERNAL CORNER BRACKET

Weight: 900g
Dimensions:
170*152.5*76.3mm

